

# **Beidou/GPS**

## **Vehicle location system**

**(GPS+GSM+Beidou+GPRS)**

### **OBD**

### **YB10-User Manual**



Please read the manual carefully before use the GPS Tracker so that you can install the device correctly and activate it quickly on the internet. The outlook and true color are subject to the actual product.

## 1. Technical parameter

- 1) . GSM: 850/900/1800/1900MHz
- 2) . GPRS: Class12,TCP/IP
- 3) . Working Voltage: 9-36V DC
- 4) . Working current:  $\approx 22\text{mA}$  (12vDC)
- 5) . Working current:  $\approx 12\text{mA}$  (24vDC)
- 6) . GPS locating time: Cold start $\approx 38\text{s}$  ( Open sky )  
Warm start $\approx 32\text{s}$   
Hot start $\approx 3\text{s}$  ( Open sky )
- 7) . GPS Precision: 10m ( 2D RM )
- 8) . Working temperature:  $-20^{\circ}\text{C} \sim +70^{\circ}\text{C}$
- 9) . Working humidity: 20% ~ 80%RH
- 10) .Measurement: 50 ( L )  $\times$  29 ( W )  $\times$  39 ( H ) mm

## 2.Out look

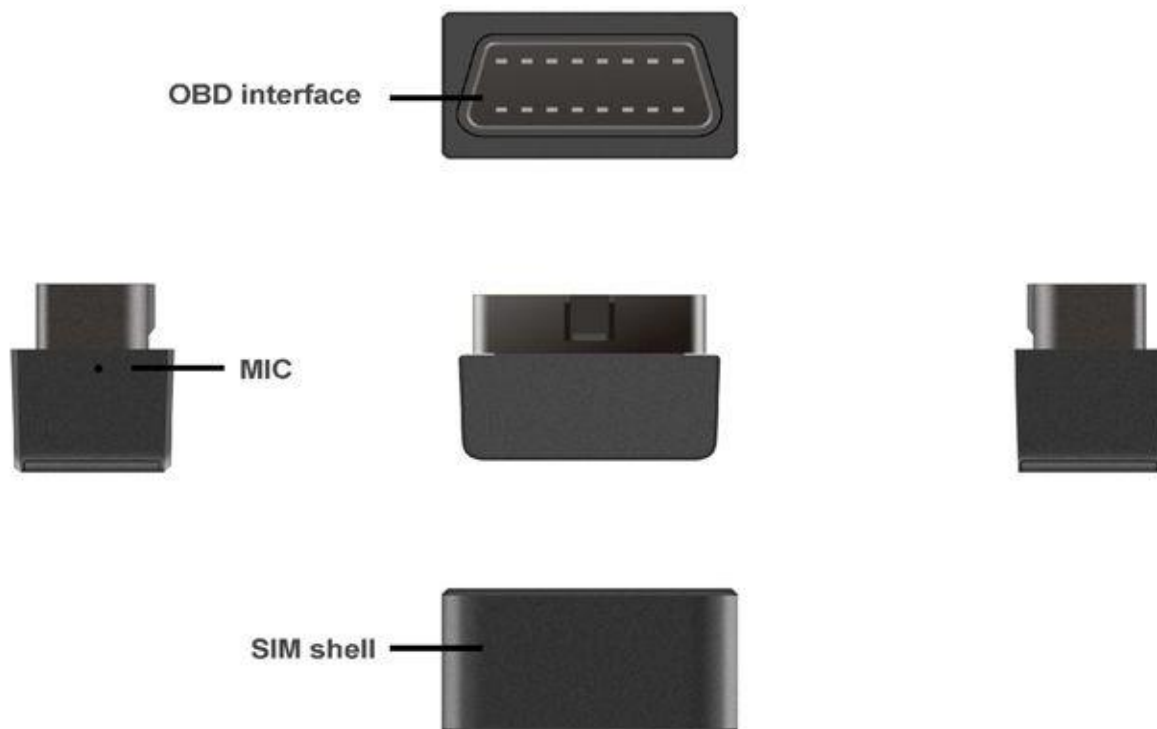

### 3. GSM card Installation

#### 3.1 Preparation for the installation

3.1.1 Product Check. Open the packing box and check the device's model and accessories. If the model is wrong or the accessories not complete, please contact the dealer.

3.1.2 Choose SIM card. Please insert a SIM card to the device. Please take dealer's advice as reference.

3.1.3 GSM installation, first open the back cover, into the SIM card (mediu card), then close the back cover.

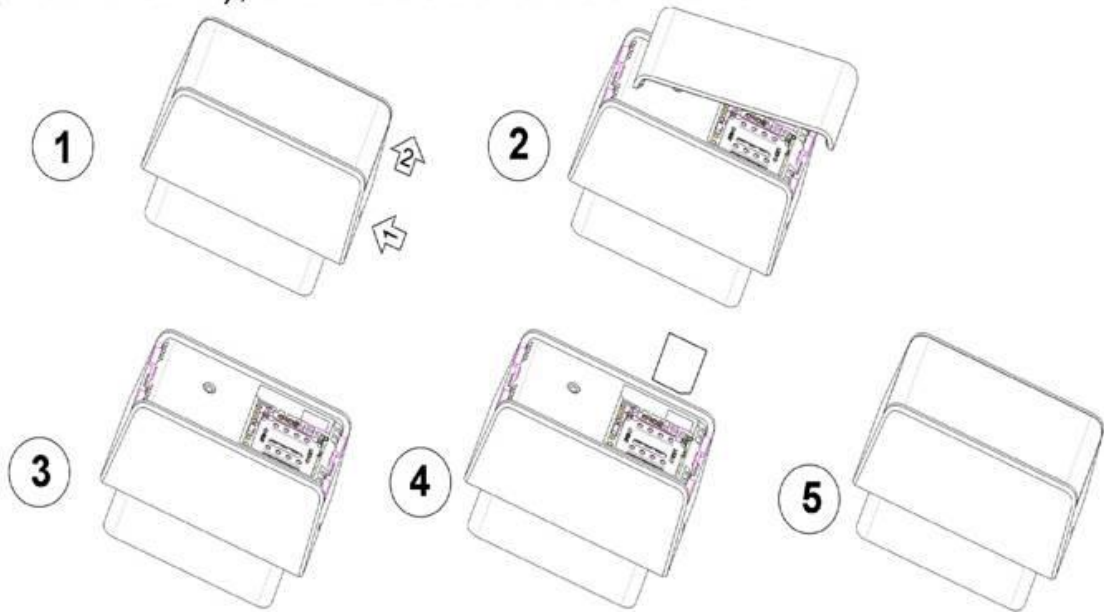

3.1.4 At this point can be connected to external 9-36 v power supply

Note: don't install backwards the terminal GSM card

The GSM card must be with GSM function and enough deposit.

If your GSM card need input PIN when power on, please referr your phone's user manual and cancel it.



## 4. How to find the car's OBD connector locations

connect the devices to the car OBD interface

**Mode 1: find a sticker under the hood , find words:**

**"OBDII CERTIFIED"**



**Mode 2: OBD interface is found under the steering wheel**



## 5. Terminal Working

5.1 opening: after the terminal is connected to the power, please pay attention to whether the SIM card has been inserted, if the SIM card is not inserted, external power is disconnected, and then the SIM card is inserted.

After the equipment is opened, the indicator light is opened.

When the external power supply connects +GPS to +GSM normal, the indicator light is often bright; when the GPS is normal in +GSM and the outer electricity is not connected, the indicator light is flash; when the GSM is normal + electric connection, and when the GPS is not positioned, the indicator flashes (1.5 seconds, 0.5 seconds open); when the GPS positioning + electric connection is connected, and the GSM network is not normal, the light flashes ( 3 seconds to flash, 0.5

seconds to open); when the GSM network is abnormal, +GPS is not positioned and the external power is disconnected, the indicator light is not lighted.

5.2 turn off: pull out the power adapter, turn off the power after the terminal is down.

## 6. User instruction

<b>(1) CENTER</b>		
Text command	Parameter	Sample
ADD	CENTER,A,number#	CENTER,A,13500135000#
DEL	CENTER,D#	CENTER,D#
Description	1) center number can be used to send short message instructions to restore the factory settings 2) the central number is also the function of SMS and telephone reception.	
Feedback	SET CENTER OK!	

<b>(2) APN</b>		
Text command	Parameter	Sample
Parameter	APN, apn [,username, password]	1: APN,intenet,123,123# 2: APN,cmnet#
Description	APN differs according to the local telecom operators.Users have to confirm the APN parameter For example: APN request password, please refer to Sample1, and Sample2 for no password.	
Feedback	SET APN OK!	

### (3) TIMER

Text command	Parameter	Sample
Parameter	TIMER,uploading interval#	TIMER,30#
Description	Time scope: 10~60 seconds; 10~60,means time interval; the default value is 10 seconds!	
Feedback	SET TIMER OK!	

### (4) SERVER

Text command	Parameter	Sample
Parameter	SERVER, <a href="#">code</a> , domain/IP,port#	SERVER,8520,d.gps18.com,7700#
Description	This function changes the server settings, you need to modify the server IP / domain name and port. Port Range: 10 ~ 65535; wherein Password: 8520; Domain: either domain name or an IP address.	
Feedback	SET SERVER OK!	

### (5) 123

Text command	Parameter	Sample
Format	123	123
Description	This command is used to query the current location description	
Feedback	Example: No.166,Chaoyang East Road,Dashi Town, Panyu,Guangzhou	

## **(6) GMT**

Text command	Parameter	Sample
Parameter	GMT, direction , time zone[, half time zone]	1) GMT,E,8# 2) GMT,E,6,30#
Description	The default time zone on the terminal is the Beijing time zone E8, if need to change the time zone,need to send the above instructions.Range: E/W, 0~12	
Feedback	SET GMT OK!	

## **(7) VIBRATION**

Text command	Parameter	Sample
VIBRATION Parameter	VIBRATION, alarming level[,alarming way]#	1)VIBRATION,2,3# 2)VIBRATION,2#
Description	Set vibration alarm Alarm levels is from 0 to 5, the lower level the more sensitive and 0 is close. Alarming ways: 1, calling 2, texting, 3 calling and texting. Default :1.calling ;you don't have to chose the alarming way such as sample 2; Must set the center number and receiving number.	
Feedback	SET VIBRATION OK!	

## **(8) RESET**

Text command	Parameter	Sample
RESET	RESET#	RESET#
Description	Reset the device	
Feedback	RESET OK!	

## **(9) FACTORY**

Text command	Parameter	Sample
Parameter	FACTORY#	FACTORY#
Description	This instruction is to restore the factory settings Restore factory settings after all users to add and modify the content will be restored!	
Feedback	SET FACTORY OK!	

## **(10) LISTEN**

Text command	Parameter	Sample
Parameter	LISTEN,0~1#	1)LISTEN,1# 2)LISTEN,0#
Description	This instruction is used to set up the monitor, range 0~1, the function of the default is a semi closed; If you need to turn on the sample 1 to send the instruction, if you need to close the case by case 2; Set the number must be the central number; Equipment used by the SIM card must have caller ID function;	
Feedback	SET LISTEN OK!	



<b>(11) PARAM</b>		
Text command	Parameter	Sample
PARAM	PARAM#	PARAM#
Description	The command is to check the settings and the default parameter.	
Feedback	IMEI:351190012535888 APN:cmnet IP:d.gps18.com :7700 UPLOADING TIME:15S LANG:Chinese GMT: time zone (E/W8)	device IMEI operator GPRS node sever IP and port moving uploading interval language(CN/EN) time zone(E/W 0~12)

<b>(12) STATUS</b>		
Text command	Parameter	Sample
STATUS	STATUS#	STATUS#
Description	The command is designed for checking the device's working status.	
Feedback	BATTERY:100% GSM Signal: strength GPS:FIXED GPS Signal: strength Charging:connect voltage :13, 4.18	-- Battery status (SOC) --GSM Signal strength --GPS Location condition --GPS Signal strength -- power state -- power&battery voltage (volts)

<b>(13) POWER</b>		
Text command	Parameter	Sample
Parameter	POWER0#	POWER0# alert message OFF
	POWER1#	POWER1# alert message ON
Description	This instruction is used to set up the device external power off, whether to the center number of SMS alert; Default state is: POWER1 alert;	
Feedback	SET POWER OK!	

<b>(14) URL</b>		
Text command	Parameter	Sample
URL	URL#	URL#
Description	Check the location link of Google map	
Feedback	<Datetime:18-10-09 18:21:30> <a href="http://maps.google.com/maps?q=N23.0552648886,E114.4423547004">http://maps.google.com/maps?q=N23.0552648886,E114.4423547004</a>	

<b>(15) FEE</b>		
Command	Parameter	Sample
Format	FEE,Query number,contents#	FEE,10010,102# FEE,10086,101#
Description	This instruction is used to query the current calls status of the device SIM card Query number: SIM is the operator of the query number Content: the contents of the query, such as mobile CXYE is the balance of the query	
Feedback	Return the call query results returned by the operator	

**Note:**A comma in command must be a comma in English

## **7. Trouble shooting**

**7.1** The device is not online or offline on the web platform

**7.1.1** First, please check whether the three indicator is normal or not, if there's no condition for observation, Please use the cell phone to call the terminal SIM card number, according to the reminding tone to determine the status of the terminal.

If not connected, Indicating that the terminal temporarily cannot connect or the GSM signals cannot reach your location

Terminal area may not be covered by the GSM signal or weak signal in the basement and other places, please drive to the open sky.

If not connected, suggesting that the Terminal is insufficient Or has been shut down

- If reminding the device SIM card is out of deposit, please recharge it. If you can connect to the device when calling, and hear a beep. Du, du. noise the SIM card is installed correctly and has deposited and please check with your operator for GPRS function. You also can check by searching the internet on your mobile phone. If you can not open website, the GPRS function has not open. please contact with the operator to open
- If the terminal is not connected and reminding shutdown

## **8.GPRS tips**

SIM card using monthly traffic service, to save the bill; if the vehicles per day for a long time in the motion state, please the upload time interval to change some, such as timer, 30# change for motion state in 30 seconds to upload a data to prevent excessive flow ultra unnecessary losses;

## 9. After sales service

- 1.If products has technical changes ,we've no prior notice.
- 2.The shape and color, please in kind prevail
- 3.Warranty card applies to the specified IMEI number in the following table
- 4.Please properly keep this card and receipt in case of after-sales service
- 5.The following is for the warranty reference

NAME		TELEPHONE NUMBER	
ADDRESS			
TYPE		IMEI	
<ol style="list-style-type: none"><li>1. Hosts are guaranteed for 12 months, from date of purchase which products are not being damaged by any man-made factors</li><li>2. Listed below are the situation which is not covered under the warranty, users need to pay maintenance fees<ol style="list-style-type: none"><li>(1) Beyond the warranty period</li><li>(2) maintenance and repair by disassembling the machine without authorization</li><li>(3) Soak, damage or burn circuit board</li><li>(4) Installation, use, maintenance or improper storage</li><li>(5) Housings, lenses or internal damage to the antenna</li><li>(6) IMEI number tearing or blurred</li><li>(7) Warranty certificate inconsistent with the product model or has been modified</li><li>(8) Damage caused by irresistible force</li></ol></li></ol>			